

## Flange Mtg.: A3HG100-FR01KK-E1D/E2D/U1D/U2D/J1D

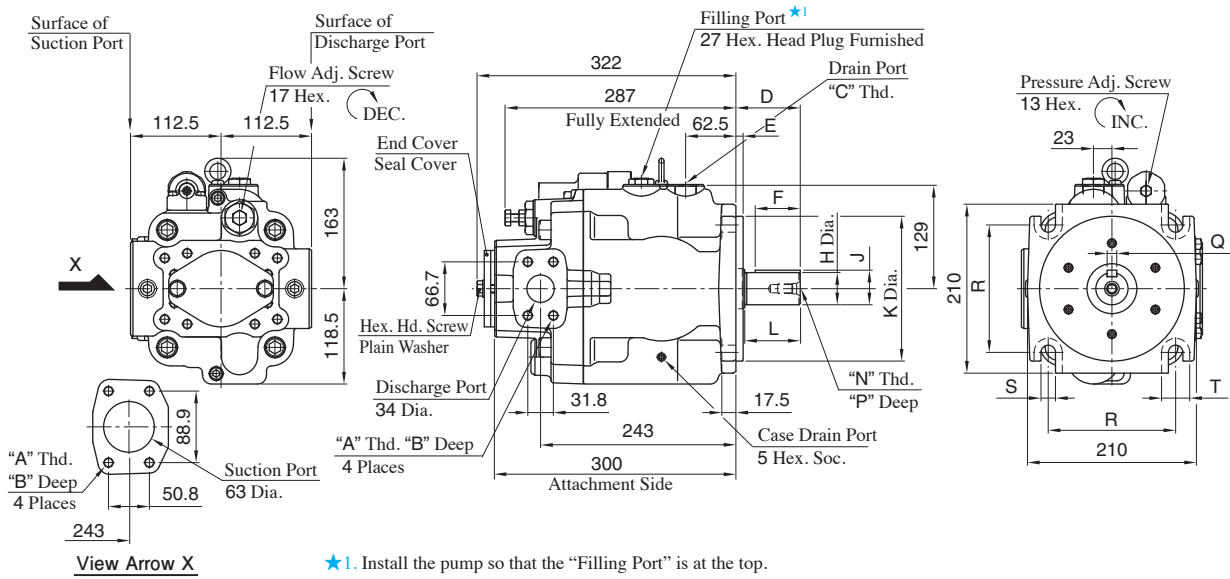

$\star 1$ . Install the pump so that the "Filling Port" is at the top.

Model Numbers	A	B	C	D	E	F	H	J	K	L	N	P	Q	R	S	T	Mounting Flange	Connecting Port	Pipe Flange Threads
A3HG100-FR01KK-E1D/E2D	M12	22	M27X2	80	9	56	40 <sup>+0.018</sup> / <sub>+0.002</sub>	43 <sup>+0.018</sup> / <sub>-0.288</sub>	180 <sup>0</sup> / <sub>-0.063</sub>	70	M12	28	12 <sup>0</sup> / <sub>-0.043</sub>	158.4	18	35	Conforms to ISO 3019-2	Metric	Metric
A3HG100-FR01KK-U1D	1/2-13 UNC	21	G 3/4	62	12.7	45	38.1 <sup>0</sup> / <sub>-0.05</sub>	42.36 <sup>0</sup> / <sub>-0.18</sub>	152.4 <sup>0</sup> / <sub>-0.05</sub>	54		28	9.53 <sup>+0.03</sup> / <sub>0</sub>	161.6	21.5	39	Conforms to ISO 3019-1	Unified	Unified
A3HG100-FR01KK-U2D	M12	22	G 3/4	62	12.7	45	38.1 <sup>0</sup> / <sub>-0.05</sub>	42.36 <sup>0</sup> / <sub>-0.18</sub>	152.4 <sup>0</sup> / <sub>-0.05</sub>	54	7/16-14 UNC	28	9.53 <sup>+0.03</sup> / <sub>0</sub>	161.6	21.5	39	Conforms to ISO 3019-1	BSPP	Metric
A3HG100-FR01KK-J1D	M12	22	G 3/4	62	12.7	45	38.1 <sup>0</sup> / <sub>-0.05</sub>	42.36 <sup>0</sup> / <sub>-0.18</sub>	152.4 <sup>0</sup> / <sub>-0.05</sub>	54		28	9.53 <sup>+0.03</sup> / <sub>0</sub>	161.6	21.5	39	Conforms to ISO 3019-1	Rc	Metric

### Drain Port

For Port/Flange Code "U1/J1", Adapter and bonded seal are attached. After installing the bonded seal at the drain port tighten the adapter

#### Detail: A3HG100-FR01KK-E1D/E2D

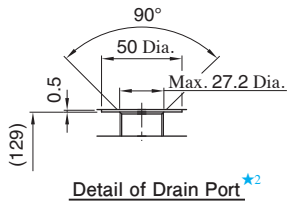

Detail of Drain Port  $\star 2$

$\star 2$ . Drain port conforms to ISO 9974-1, metric threads.

#### Accessories: A3HG100-FR01KK-U1D

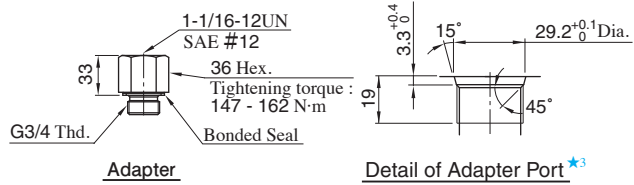

$\star 3$ . Adapter port conforms to SAE J 514, O-Ring seals.

#### Detail: A3HG100-FR01KK-U2D

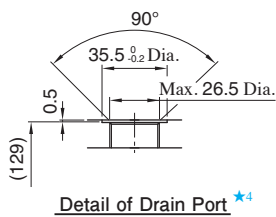

Detail of Drain Port  $\star 4$

$\star 4$ . Drain port conforms to ISO 1179-1, BSPP threads.

#### Accessories: A3HG100-FR01KK-J1D

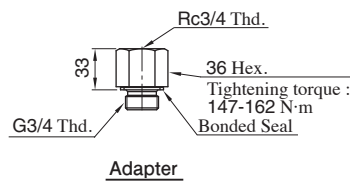

### Foot Mtg.: A3HG100-LR01KK-E1D/E2D/U1D/U2D/J1D

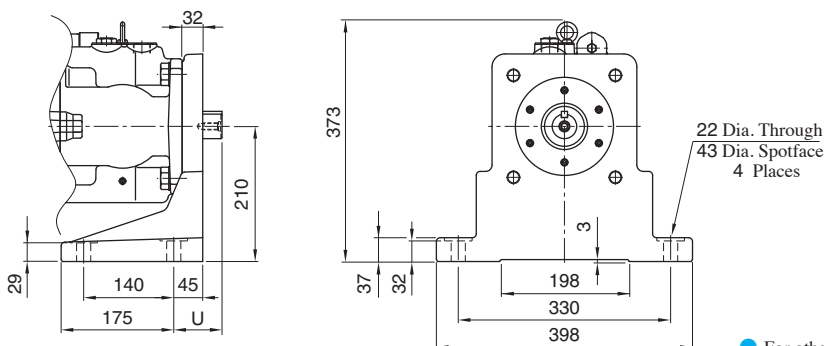

Model Numbers	U
A3HG100-LR01KK-E1D/E2D	93
A3HG100-LR01KK-U1D/U2D/J1D	75

For other dimensions, refer to "Flange Mtg."