

Flange Mtg.:A3HG16-FR07K-E1C/U1C/U2C/J1C

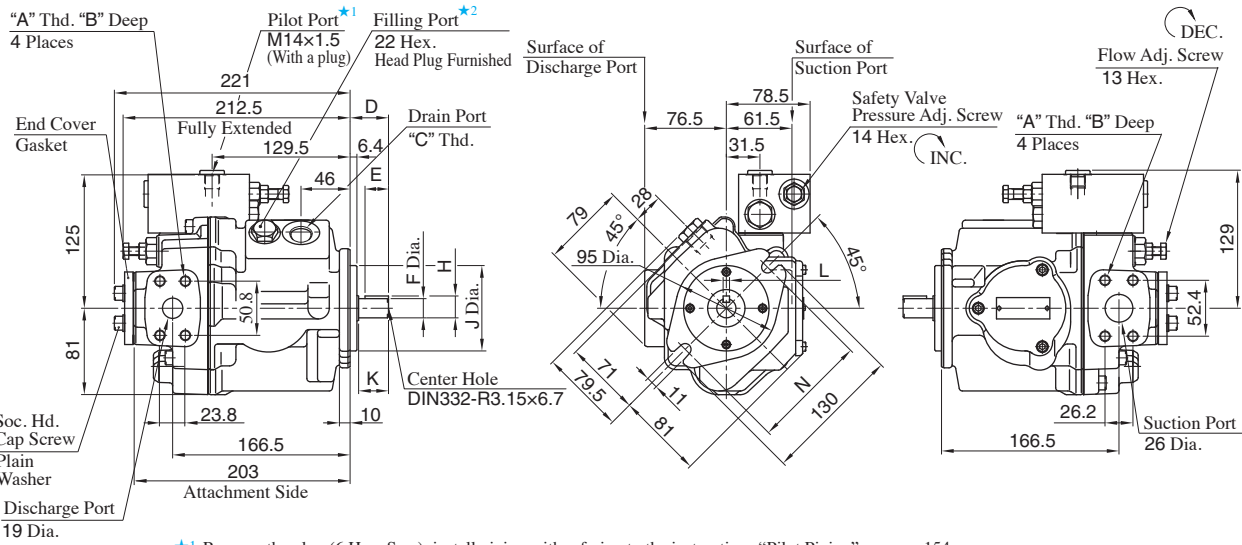

- ★1. Remove the plug (6 Hex. Soc.), install piping with referring to the instructions "Pilot Piping" on page 154.
- ★2. Install the pump so that the "Filling Port" is at the top.

Model Numbers	A	B	C	D	E	F	H	J	K	L	N	Mounting Flange	Connecting Port	Pipe Flange Threads
A3HG16-FR07K-E1C	M10	19	M22 x 1.5	36	22	18 ^{+0.008} _{-0.003}	20.5 ^{+0.008} _{-0.133}	80 ⁰ _{-0.046}	28	6 ⁰ _{-0.03}	109	Conforms to ISO 3019-2	Metric	Metric
A3HG16-FR07K-U1C	3/8-16 UNC	17	G 1/2	41	28	19.05 ⁰ _{-0.03}	21.24 ⁰ _{-0.16}	82.55 ⁰ _{-0.05}	33	4.76 ^{+0.03} ₀	106	Conforms to ISO 3019-1	Unified	Unified
A3HG16-FR07K-U2C	M10	19	G 1/2	41	28	19.05 ⁰ _{-0.03}	21.24 ⁰ _{-0.16}	82.55 ⁰ _{-0.05}	33	4.76 ^{+0.03} ₀	106	Conforms to ISO 3019-1	BSP	Metric
A3HG16-FR07K-J1C	M10	19	G 1/2	41	28	19.05 ⁰ _{-0.03}	21.24 ⁰ _{-0.16}	82.55 ⁰ _{-0.05}	33	4.76 ^{+0.03} ₀	106	Conforms to ISO 3019-1	Rc	Metric

Pilot Port

For Port/Flange Code "U1/U2/J1", Adapter and O-Ring are attached. After installing the O-Ring at the drain port tighten the adapter

● Detail:A3HG16-FR07K-E1C

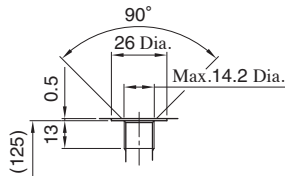

Detail of Pilot Port ★3

★3. Pilot port conforms to ISO 9974-1, metric threads.

● Accessories:A3HG16-FR07K-U2C

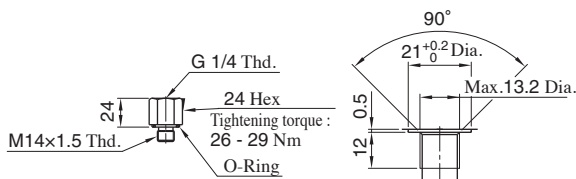

Adapter

Detail of Adapter Port ★5

★5. Adapter port conforms to ISO 1179-1, BSP threads.

● Accessories:A3HG16-FR07K-U1C



Adapter

Detail of Adapter Port ★4

★4. Adapter port conforms to SAE J 514, O-Ring seals

● Accessories:A3HG16-FR07K-J1C

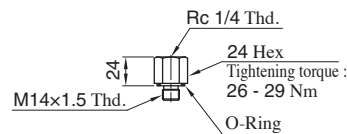

Adapter

Drain Port

Drain Port is common to that of pressure compensator model. Refer to page 167 for the dimensions of Drain Port.

Foot Mtg.:A3HG16-LR07K-E1C/U1C/U2C/J1C

Mounting bracket is common to that of pressure compensator model (except max height dimension). Refer to page 167 for the dimensions of mounting bracket.